

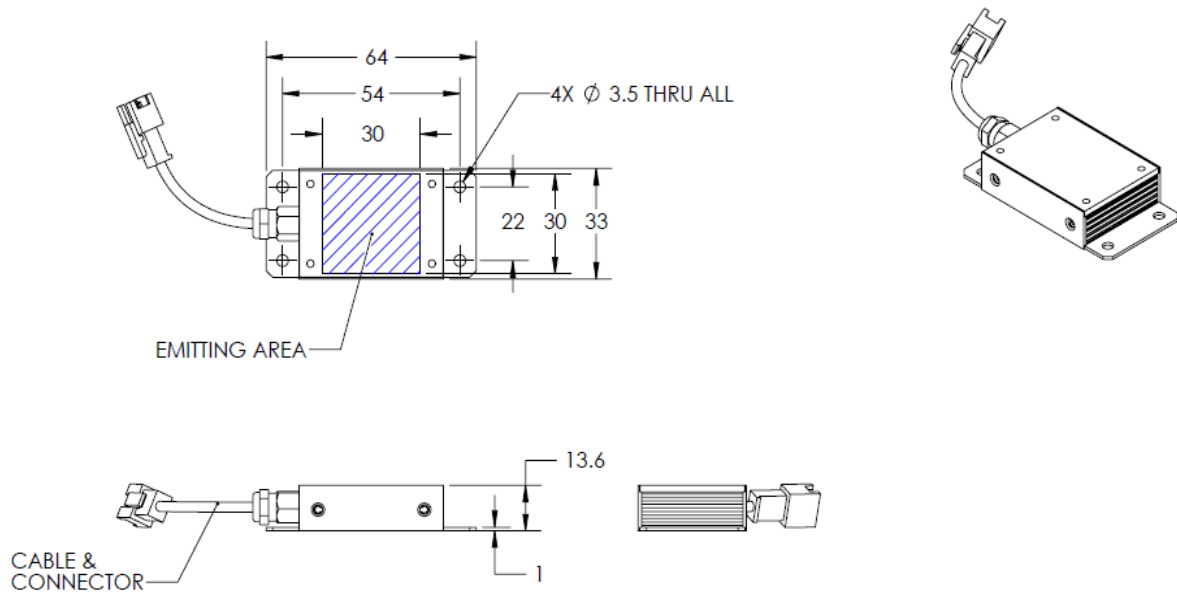

# ILLUMINATOR DATA-ID

**BHS4-00-030-X-W-24V**

## Lighting Dimension



Mechanical Information	
Casing Material	Aluminium
Storage Temperature Range	Temp 0-45°C, Humidity 20-85%
Weight	50 g
Length / Outer Diameter	64 mm
Width / Inner Diameter	33 mm
Thickness / Height	13.6 mm



# ILLUMINATOR DATA-ID

## BHS4-00-030-X-W-24V

Optical Information																													
Part Number		BHS4-00-030-X-W-24V																											
LED Color		WHITE																											
Wavelength	(nm)	*Refer to the Chromaticity Table below																											
Intensity (±15%)	(Lux)	19642.5	10921.5	6534																									
Working Distance	(mm)	10	20	30																									
Illumination (number of row)		X																											
Illumination Active Area																													
Active Length / Outer Diameter	(mm)	30																											
Active Width / Inner Diameter	(mm)	30																											
Emission angle	(deg.)	0																											
Eye Safety Class ( IEC62471 )		EXEMPT																											
*CHROMATICITY TABLE		<table border="1"> <tr> <td>X</td> <td>0.296</td> <td>0.287</td> <td>0.307</td> <td>0.311</td> <td></td> </tr> <tr> <td>Y</td> <td>0.276</td> <td>0.295</td> <td>0.315</td> <td>0.294</td> <td></td> </tr> </table> <table border="1"> <tr> <td>X</td> <td>0.311</td> <td>0.307</td> <td>0.33</td> <td>0.33</td> <td></td> </tr> <tr> <td>Y</td> <td>0.294</td> <td>0.315</td> <td>0.339</td> <td>0.318</td> <td></td> </tr> </table>				X	0.296	0.287	0.307	0.311		Y	0.276	0.295	0.315	0.294		X	0.311	0.307	0.33	0.33		Y	0.294	0.315	0.339	0.318	
X	0.296	0.287	0.307	0.311																									
Y	0.276	0.295	0.315	0.294																									
X	0.311	0.307	0.33	0.33																									
Y	0.294	0.315	0.339	0.318																									
Electrical Information																													
Lighting Supply Voltage (constant voltage mode)		24V ± 2%																											
Continuous Current	(mA)	24																											
Power Consumption	(W)	0.576																											
Lighting casing temperature, Operating after 60 minutes	°C	49.7																											
Strobe Mode Specification																													
Pulse Operation		YES																											
Max. Lighting Supply Voltage (Constant voltage power supply)	(V)	Pulsing at 24VDC to 48VDC, 0-10% Duty Cycle Recommended at 36VDC																											
Pulse Current, (Max. 10msec) (Constant current power supply)	(mA)	72																											
Max. Trigger Pulse Duration	(msec)	10																											
Duty Cycle		0-10%																											
Additional Information																													
Additional Cooling Method		Attached to machine part for better heat dissipation																											
Intensity Controller Selection		ANG, ST, SD and SDA Series																											
CE Conformity		YES																											
RoHS Compliance		YES																											
Connection																													
Connector Type (Default):		JST SMR-03V																											
Cable Length out from lighting :	(mm)	500																											
Pin Configuration :		Pin	Signal	Cable Color																									
		1	LED +	RED																									
		2	N.C.	---																									
		3	LED -	WHITE																									
																													
Application																													
Illumination Type		Backlight illumination																											
Applicattion Use		Lead frame inspection, shape recognition, size measurement																											



**VISION CONSULTANCY**  
MAKING THE UNSEEN VISIBLE

Thank you for downloading this document from  
[www.machine-vision-shop.com](http://www.machine-vision-shop.com)

If you have any questions, you need help composing the  
right package for your application or do you want to order?

Feel free to contact us via e-mail at [sales@vision-consultancy.nl](mailto:sales@vision-consultancy.nl) or visit our webshop.

Our vision experts are happy to help you.



Natascha Overhof



Christian Cromptoets



**VISION CONSULTANCY**

Robert Schumandomein 2  
6229 ES Maastricht  
The Netherlands

+31 (0) 438 522 651

[sales@vision-consultancy.nl](mailto:sales@vision-consultancy.nl)  
[www.machine-vision-shop.com](http://www.machine-vision-shop.com)

Scan me to visit  
[machine-vision-shop](http://machine-vision-shop)

