

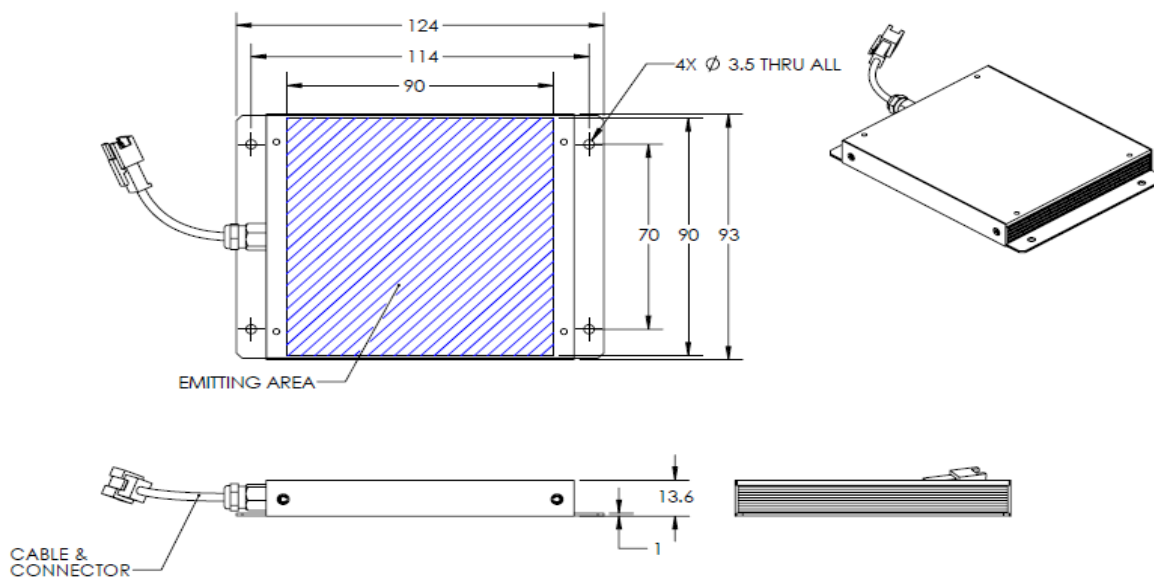

# ILLUMINATOR DATA-ID

**BHS4-00-090-X-G-24V**

## Lighting Dimension



| Mechanical Information    |                              |
|---------------------------|------------------------------|
| Casing Material           | Aluminium                    |
| Storage Temperature Range | Temp 0-45°C, Humidity 20-85% |
| Weight                    | 200 g                        |
| Length / Outer Diameter   | 124 mm                       |
| Width / Inner Diameter    | 93 mm                        |
| Thickness / Height        | 13.6 mm                      |



# ILLUMINATOR DATA-ID

## BHS4-00-090-X-G-24V

|   |        |  |        |             |
|---|--------|--|--------|-------------|
| <b>Optical Information</b>                                      |        |  |        |             |
| Part Number   |        | BHS4-00-090-X-G-24V  |        |             |
| LED Color   |        | GREEN  |        |             |
| Wavelength  | (nm)   | 525  |        |             |
| Intensity (±15%)  | (Lux)  | 43310  | 36540  | 29678       |
| Working Distance  | (mm)   | 10   | 20     | 30          |
| Illumination (number of row)                                    |        | X  |        |             |
| Illumination Active Area  |        |  |        |             |
| Active Length / Outer Diameter                                  | (mm)   | 90   |        |             |
| Active Width / Inner Diameter                                   | (mm)   | 90   |        |             |
| Emission angle  | (deg.) | 0  |        |             |
| Eye Safety Class ( IEC62471 )                                   |        | EXEMPT   |        |             |
|   |        |  |        |             |
| <b>Electrical Information</b>                                   |        |  |        |             |
| Lighting Supply Voltage<br>(constant voltage mode)              |        | 24V ± 2%   |        |             |
| Continuous Current  | (mA)   | 162  |        |             |
| Power Consumption   | (W)    | 3.88   |        |             |
| Lighting casing temperature,<br>Operating after 60 minutes      | °C     | TBA  |        |             |
|   |        |  |        |             |
| <b>Strobe Mode Specification</b>                                |        |  |        |             |
| Pulse Operation   |        | YES  |        |             |
| Max. Lighting Supply Voltage<br>(Constant voltage power supply) | (V)    | Pulsing at 24VDC to 48VDC, 0-10% Duty Cycle<br>Recommended at 36VDC                  |        |             |
| Pulse Current, (Max. 10msec)<br>(Constant current power supply) | (mA)   | 486  |        |             |
| Max. Trigger Pulse Duration                                     | (msec) | 10   |        |             |
| Duty Cycle  |        | 0-10%  |        |             |
|   |        |  |        |             |
| <b>Additional Information</b>                                   |        |  |        |             |
| Additional Cooling Method                                       |        | Attached to machine part for better heat dissipation                                 |        |             |
| Intensity Controller Selection                                  |        | ANG, ST, SD and SDA Series   |        |             |
| CE Conformity   |        | YES  |        |             |
| RoHS Compliance   |        | YES  |        |             |
|   |        |  |        |             |
| <b>Connection</b>   |        |  |        |             |
| Connector Type (Default):                                       |        | JST SMR-03V  |        |             |
| Cable Length out from lighting :                                | (mm)   | 500  |        |             |
| Pin Configuration :   |        | Pin  | Signal | Cable Color |
|   |        | 1  | LED +  | RED         |
|   |        | 2  | N.C.   | ---         |
|   |        | 3  | LED -  | WHITE       |
|   |        |  |        |             |
|   |        |  |        |             |
| <b>Application</b>  |        |  |        |             |
| Illumination Type   |        | Backlight illumination   |        |             |
| Appication Use  |        | Lead frame inspection, shape recognition, size measurement                           |        |             |



**VISION CONSULTANCY**  
MAKING THE UNSEEN VISIBLE

Thank you for downloading this document from  
[www.machine-vision-shop.com](http://www.machine-vision-shop.com)

If you have any questions, you need help composing the  
right package for your application or do you want to order?

Feel free to contact us via e-mail at [sales@vision-consultancy.nl](mailto:sales@vision-consultancy.nl) or visit our webshop.

Our vision experts are happy to help you.



Natascha Overhof



Christian Cromptoets



**VISION CONSULTANCY**

Robert Schumann  
6229 ES Maastricht  
The Netherlands

+31 (0) 438 522 651

[sales@vision-consultancy.nl](mailto:sales@vision-consultancy.nl)  
[www.machine-vision-shop.com](http://www.machine-vision-shop.com)

Scan me to visit  
[machine-vision-shop](http://machine-vision-shop)

