

## LLAC-60-070-2-G-24V

### Lighting Dimension

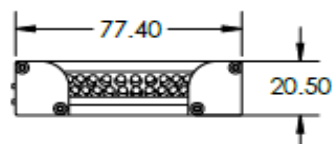

Mechanical Information	
Casing Material	Aluminium
Storage Temperature Range	0 - 45 °C
Storage Humidity Range	20 - 85 %
Weight	45g
Length / Outer Diameter	38.75mm
Width / Inner Diameter	20.5mm
Thickness / Height	20.5mm

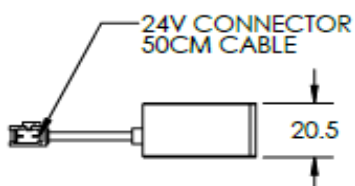
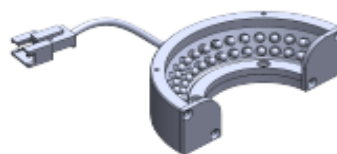
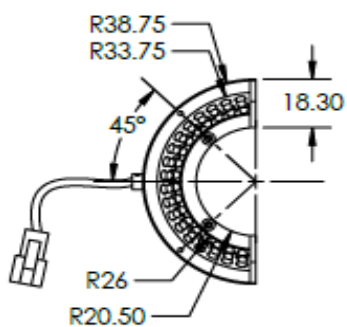

## TMS LITE SDN BHD

( Company Registration No : 200401033463 / 671971-V )

No. 2A-2, Tingkat Kenari 5, Desa Ria, Sungai Ara, 11900 Bayan Lepas, Penang, Malaysia.

Tel : +604-646 8428 Fax : +604-646 3428

Email : sales@tms-lite.com | support@tms-lite.com



## LLAC-60-070-2-G-24V

Lighting Information																																						
Part Number	LLAC-60-070-2-G-24V																																					
LED Color	GREEN																																					
Wavelength	525																																					
Working Distance	15mm		20mm		25mm																																	
Intensity (±15%)	TBA		TBA		TBA																																	
Illumination (number of row)	2																																					
Illumination Active Area	Active Length / Outer Dia.		33.75mm																																			
	Active Width / Inner Dia.		26mm																																			
Emission angle	60																																					
Eye Safety Class ( IEC62471 )	EXEMPT																																					
Chromaticity Table For White colour only	<table><tr><td>X</td><td>0.296</td><td>0.287</td><td>0.307</td><td>0.311</td><td>0.307</td><td>0.33</td><td>0.33</td></tr><tr><td>Y</td><td>0.276</td><td>0.295</td><td>0.315</td><td>0.294</td><td>X</td><td>0.311</td><td>0.307</td></tr><tr><td></td><td></td><td></td><td></td><td></td><td>Y</td><td>0.294</td><td>0.315</td></tr><tr><td></td><td></td><td></td><td></td><td></td><td></td><td>0.339</td><td>0.318</td></tr></table>						X	0.296	0.287	0.307	0.311	0.307	0.33	0.33	Y	0.276	0.295	0.315	0.294	X	0.311	0.307						Y	0.294	0.315							0.339	0.318
	X	0.296	0.287	0.307	0.311	0.307	0.33	0.33																														
Y	0.276	0.295	0.315	0.294	X	0.311	0.307																															
					Y	0.294	0.315																															
						0.339	0.318																															

Electrical Information	
LED Color	GREEN
Rated Constant Voltage	24V
Rated Constant Current	97.5mA
Power Consumption	2.34W
Casing temperature, After 60 minutes operation	TBA

Strobe Mode Specification	
**Normal Strobe Voltage	24 V
LED Color	GREEN
**Normal Strobe Current	97.5mA
Overdrive Voltage Range	Min: 36V Max: 48V
Overdrive Current Range	Min: 146.25mA Max: 195mA
Recommended Overdrive Voltage	36 V
***Max. Trigger Pulse Duration	10 msec
***Max. Duty Cycle	10 %

\*\*Normal strobe means the lighting is operated using the rated power. Overdrive means the power supplied to the lighting exceeded the rated power.

\*\*\*Overdrive condition must not exceed the max. trigger pulse duration and max. duty cycle. Failure in following this may results in damaging the lighting.



## TMS LITE SDN BHD

( Company Registration No : 200401033463 / 671971-V )

No. 2A-2, Tingkat Kenari 5, Desa Ria, Sungai Ara, 11900 Bayan Lepas, Penang, Malaysia.

Tel : +604-646 8428 Fax : +604-646 3428

Email : sales@tms-lite.com | support@tms-lite.com

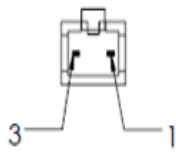

## LLAC-60-070-2-G-24V

Connection Information			
Connector Type (Default)	JST SMR-03V		
Cable Length	50 CM		
Pin Configuration	Pin	Signal	Cable Colour
	1	LED +	Red
	2	N.C	-
	3	LED -	White
	4		
	5		
 			

Additional Information	
Additional Cooling Method	Attached to machine part for better heat dissipation
Intensity Controller Selection	SD,ST,ANG,LC,SDA,SDP Series
CE Conformity	Yes
RoHS Compliance	Yes
Reach	No
BIS	No
UKCA	No

Application	
Illumination Type	Half Circle Illumination
Application Use	Edge Detection, Scratch on Metal and Glossy Surface



# TMS LITE SDN BHD

( Company Registration No : 200401033463 / 671971-V )

No. 2A-2, Tingkat Kenari 5, Desa Ria, Sungai Ara, 11900 Bayan Lepas, Penang, Malaysia.

Tel : +604-646 8428 Fax : +604-646 3428

Email : sales@tms-lite.com | support@tms-lite.com



## LLAC-60-070-2-G-24V

Lighting Pattern																																																																					
LED Color	GREEN																																																																				
Working Distance																																																																					
Display and Image																																																																					
Data Results	<table><tr><td colspan="2">Horizontal</td><td>Meas.(mm)</td><td colspan="2">Vertical</td><td>Meas.(mm)</td></tr><tr><td colspan="2">90%</td><td></td><td colspan="2">90%</td><td></td></tr><tr><td colspan="2">80%</td><td></td><td colspan="2">80%</td><td></td></tr><tr><td colspan="2">70%</td><td></td><td colspan="2">70%</td><td></td></tr><tr><td colspan="2">60%</td><td></td><td colspan="2">60%</td><td></td></tr><tr><td colspan="2">50%</td><td></td><td colspan="2">50%</td><td></td></tr><tr><td colspan="2">40%</td><td></td><td colspan="2">40%</td><td></td></tr><tr><td colspan="2">30%</td><td></td><td colspan="2">30%</td><td></td></tr><tr><td colspan="2">20%</td><td></td><td colspan="2">20%</td><td></td></tr><tr><td colspan="2">10%</td><td></td><td colspan="2">10%</td><td></td></tr></table> <table><tr><td>Max</td><td>Meas.(cd/m2)</td></tr><tr><td></td><td></td></tr></table>					Horizontal		Meas.(mm)	Vertical		Meas.(mm)	90%			90%			80%			80%			70%			70%			60%			60%			50%			50%			40%			40%			30%			30%			20%			20%			10%			10%			Max	Meas.(cd/m2)		
Horizontal		Meas.(mm)	Vertical		Meas.(mm)																																																																
90%			90%																																																																		
80%			80%																																																																		
70%			70%																																																																		
60%			60%																																																																		
50%			50%																																																																		
40%			40%																																																																		
30%			30%																																																																		
20%			20%																																																																		
10%			10%																																																																		
Max	Meas.(cd/m2)																																																																				



**VISION CONSULTANCY**  
MAKING THE UNSEEN VISIBLE

Thank you for downloading this document from  
[www.machine-vision-shop.com](http://www.machine-vision-shop.com)

If you have any questions, you need help composing the  
right package for your application or do you want to order?

Feel free to contact us via e-mail at [sales@vision-consultancy.nl](mailto:sales@vision-consultancy.nl) or visit our webshop.

Our vision experts are happy to help you.



Natascha Overhof



Christian Cromptoets



**VISION CONSULTANCY**

Robert Schumann domein 2  
6229 ES Maastricht  
The Netherlands

+31 (0) 438 522 651

[sales@vision-consultancy.nl](mailto:sales@vision-consultancy.nl)  
[www.machine-vision-shop.com](http://www.machine-vision-shop.com)

Scan me to visit  
[machine-vision-shop](http://machine-vision-shop)

