

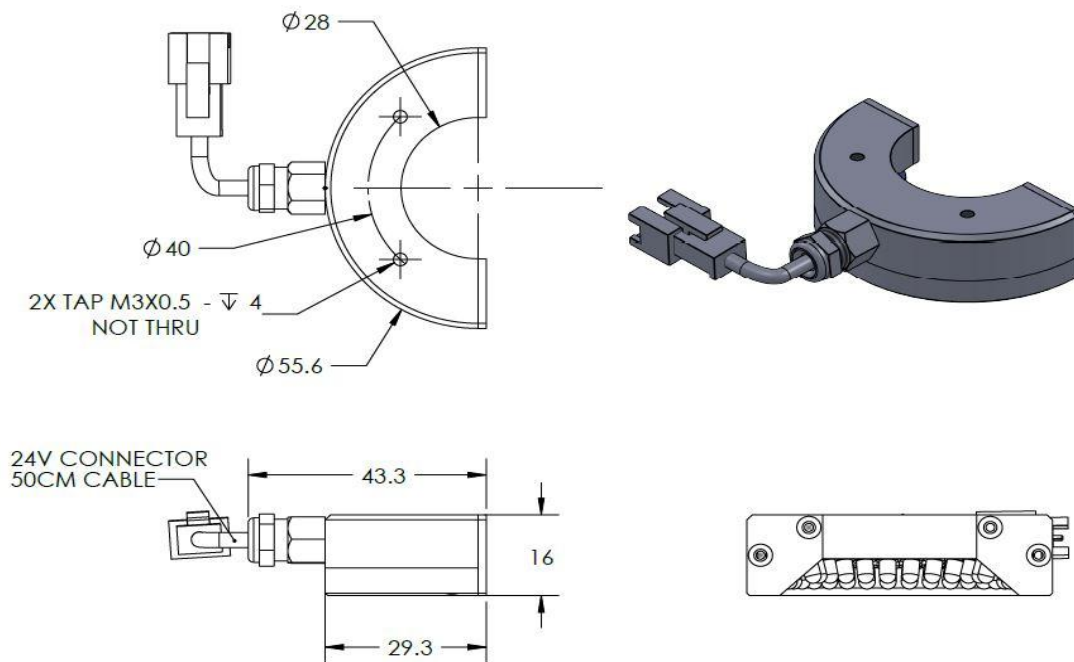

ILLUMINATOR DATA (ID)

LSWC-15-050-2-R-24V

Lighting Dimension



Mechanical Information

Casing Material	Aluminium
Storage Temperature Range	0 - 45°C
Storage Humidity Range	20 - 85%
Weight	50 g
Length / Outer Diameter	55.6 mm
Width / Inner Diameter	28 mm
Thickness / Height	16 mm



ILLUMINATOR DATA (ID)

LSWC-15-050-2-R-24V

Lighting Information			
Part Number	LSWC-15-050-2-R-24V		
LED Color	RED		
Wavelength	630		
Working Distance	64 mm	69 mm	74 mm
Intensity (±15%)	TBA	TBA	TBA
Illumination (number of row)	1		
Illumination Active Area	Active Length / Outer Dia.	43.6 mm	
	Active Width / Inner Dia.	28.8 mm	
Emission angle	15		
Eye Safety Class (IEC62471)	EXEMPT		
Chromaticity Table	NIL		
For White colour only			

Electrical Information	
Rated Constant Voltage	24V $\pm 2\%$
Rated Constant Current	60 mA
Power Consumption	1.44 W
Casing temperature, After 60 minutes operation	62.1 °C

Strobe Mode Specification		
*Normal Strobe Voltage	24 V	
*Normal Strobe Current	60 mA	
Overdrive Voltage Range	Min: 36 V	Max: 48 V
Overdrive Current Range	Min: 0.13 A	Max: 0.24 A
Recommended Overdrive Voltage	36 V	
**Max. Trigger Pulse Duration	10 msec	
**Max. Duty Cycle	10%	

*Normal strobe means the lighting is operated using the rated power. Overdrive means the power supplied to the lighting exceeded the rated power.

**Overdrive condition must not exceed the max. trigger pulse duration and max. duty cycle.





ILLUMINATOR DATA (ID)

LSWC-15-050-2-R-24V

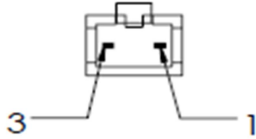
Connection Information			
Connector Type (Default)	JST SMR-03V		
Cable Length	50 cm		
Pin Configuration 	Pin	Signal	Cable Colour
	1	LED +	Red
	2	N.C	-
	3	LED -	White
			

Additional Information	
Additional Cooling Method	Attached to machine part for better heat dissipation
Intensity Controller Selection	SD, ST, ANG, LC, SDA, SDP series
CE Conformity	YES
RoHS Compliance	YES

Application	
Illumination Type	Half Circle Illumination
Application Use	Edge Detection, Scratch on Metal or Glossy Surface



ILLUMINATOR DATA (ID)

LSWC-15-050-2-R-24V

Lighting Pattern				
Working Distance	For further details please contact us			
Display and Image				
Data Results	Horizontal	Meas.(mm)	Vertical	Meas.(mm)
	90%		90%	
	80%		80%	
	70%		70%	
	60%		60%	
	50%		50%	
	40%		40%	
	30%		30%	
	20%		20%	
	10%		10%	



VISION CONSULTANCY
MAKING THE UNSEEN VISIBLE

Thank you for downloading this document from
www.machine-vision-shop.com

If you have any questions, you need help composing the
right package for your application or do you want to order?

Feel free to contact us via e-mail at sales@vision-consultancy.nl or visit our webshop.

Our vision experts are happy to help you.



Natascha Overhof



Christian Cromptoets



VISION CONSULTANCY

Robert Schumann domein 2
6229 ES Maastricht
The Netherlands

+31 (0) 438 522 651

sales@vision-consultancy.nl
www.machine-vision-shop.com

Scan me to visit
machine-vision-shop

